



4th Floor, Sheron Plaza, opp. Ambaniketan bus stop,
Athwa Lines, Parle Point, Surat

Notes :

All rights reserved by organiser to make any changes in specification, plan, elevation and other details therein, which shall be binding to all all member. | Vat, Service tax, G.S.T. as 6 if applicable will be born by the purchaser/member. | Stampduty, registration charges, legal charges, GEB charges, SUDA charges, society maintenance charges to be borne by purchaser. Any new taxes announced by the Govt./SMC/any authority will be paid by the purchaser/member. | Changes in external elevator shall not be allowed. | This Brochure is not legal document. Purpose for Brochure is only presentation. | All matter subject to surat jurisdiction.



PTM



PADMAVATI TEXTILE MARKET



Surat's
Most Spacious
Textile Market



NTM Side view



Entry from Ring Road



Basement parking

AMENITIES

Decorative Entrance foyer

Large size Centre Passage of 15' ft. & Internal Passages of 10' ft. for customer convenience

High-Tech security system with close circuit cameras in all passages with 24 hrs. monitoring.

Central R.O. system and water cooler for pure cold drinking water on all floors.

Public address system in all passages on all floors.

Generator for common lighting, lifts and water pumps.

Telephone cable network in all shops.

Car and scooter parking at Basement level.

Separate area for tempo loading and unloading.

Basic size of shop on G.F. 10' x 20' & 10' x 15' on Typical floor. Excess sq.ft. area will be charged extra.

Surat's
 Most Spacious
 Textile Market

ENTRY

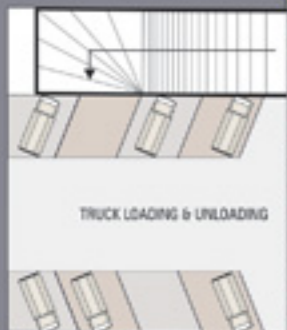

GROUND FLOOR PLAN



HIGHER GROUND FLOOR PLAN



FIRST FLOOR PLAN

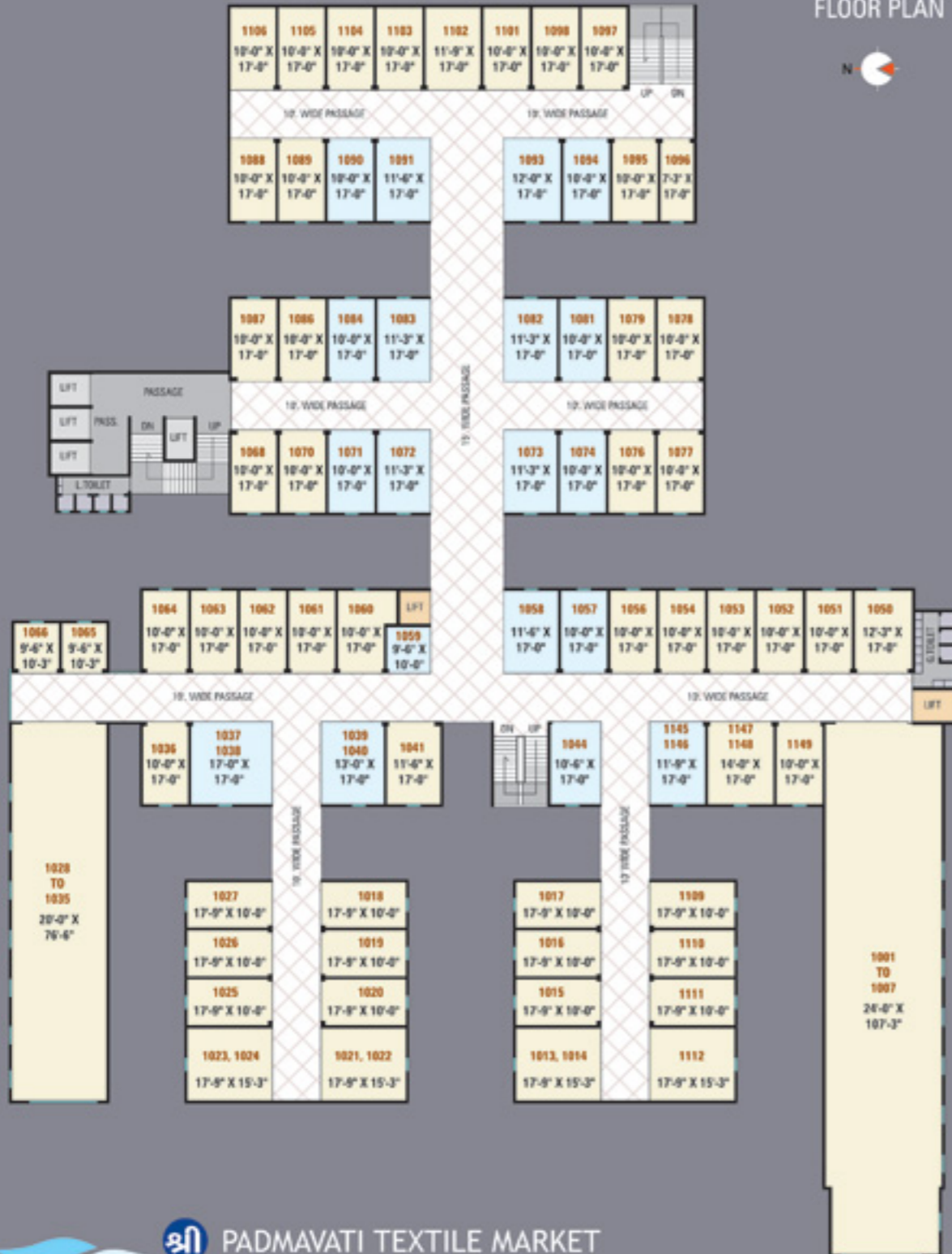

SECOND FLOOR PLAN

